

A quick 3 step guide to measuring your outdoor heating project

Measure, record, submit.

Please follow this quick guide and send us your measurements so we can accurately quote your outdoor heating project

STEP 1

Measuring a table against a wall

This section focuses on spot heating people sat at a table that is against a wall. To quote an area like this, all we require is the dimensions of the area that is occupied by a person (red lines) and the depth of the bench/table (green line).

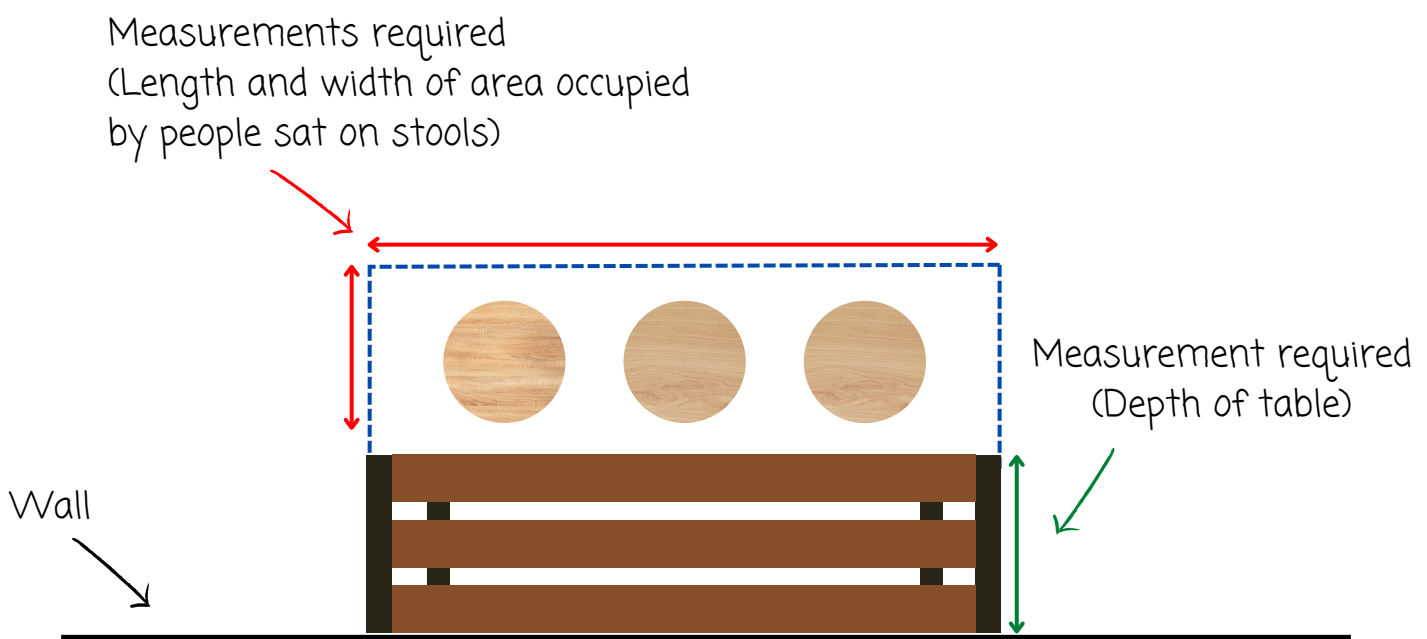

Rule of thumb, we usually aim to heat about a meter away from the edge of the table to make sure we are covering the people sat on stools.

STEP 1

Measuring a larger outdoor area

This section focusses on heating a larger outdoor area. Here we'll demonstrate how to measure a large open sided gazebo.

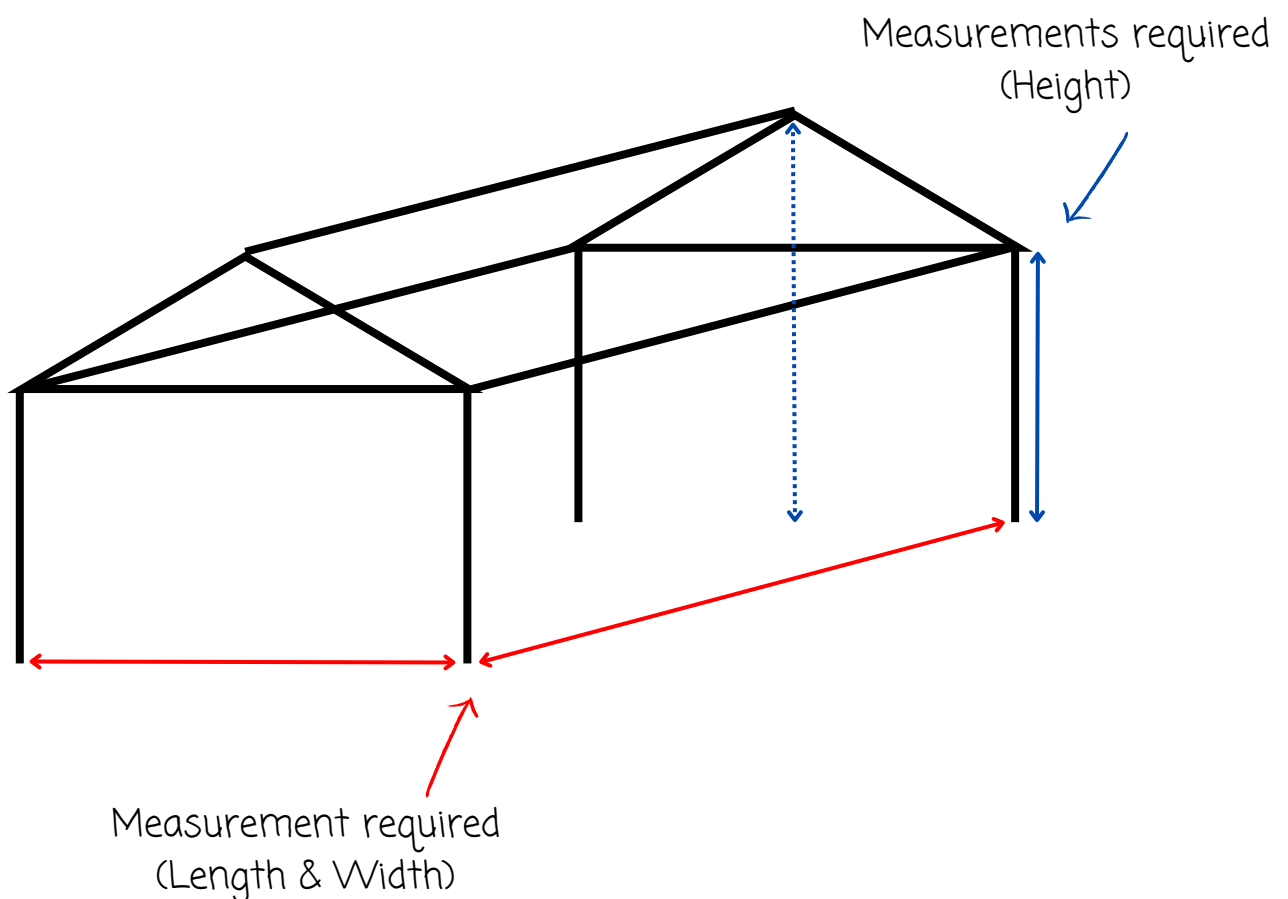

A gazebo tends to have a pitched roof so it is important to provide us with two height measurements. One from the floor to the eaves (solid blue line) and one from the floor to the apex of the roof (dotted blue line).

STEP 2

Recording your measurements

Once submitted, we'll will use your measurements to work out how many kW your project requires and which heaters are most suitable. It is vital the measurements are as accurate as possible.

Here's an examples of how we record the measurements of a spot Heating project. We would recommend following this.

- For a small project, this is the most simple way to record your measurements and gives us all the info we need
- Here state what colour heater you require
- Sending a dimensioned sketch is again very handy for our design team
- For the gazebo project, all we really require is the dimensions and an idea of what framework is present (red lines) that we could mount heaters on

Option 1 - a table next to wall

Number of tables: 1
Dimension of table: 3 x 1m
Dimension of occupied area: 3 x 1m

Looking to wall mount a black heater with a zero glare magic lamp

Option 2 - gazebo heating project

STEP 3

Submitting your measurements

Once you have measured your area, it is now time to submit your measurements to us. Our design team will then put together a heating scheme and email you a detailed proposal.

How to contact us:



Email: sales@bnthermic.co.uk (*preferred method*)



Phone: 01293 547 361



WhatsApp: 07518 574 345